



VIEW FENCE, TYP.
 TOP OF BANK
 8' ASPHALT. PUBLIC TRAIL, TYP.
 FITNESS STATION, TYP.
 LITTLE DUTCH SLOUGH
 FITNESS STATION, TYP.
 PLANTING AREA, TYP.
 FITNESS STATION, TYP.
 FITNESS STATION, TYP.
 SOUND WALL, TYP.

VIEW FENCE, TYP.
 GOOD NEIGHBOR FENCE, TYP.
 8' ASPHALT PUBLIC TRAIL, TYP.
 NEW TREE, TYP.
 SOUND WALL, TYP.
 SEATING, TYP.
 REMOVABLE BOLLARD, TYP.
 EVA EMERGENCY VEHICLE ACCESS PER CIVIL PLANS

VAN DORN ABED
 LANDSCAPE ARCHITECTS, INC.
 81 14TH STREET, SAN FRANCISCO, CA
 ZIP 94103 PH (415) 864-1921 FAX (415) 864-4796

WESTGATE VENTURES
 CITY OF OAKLEY
BURROUGHS
 OAKLEY, CALIFORNIA

CONCEPTUAL LANDSCAPE PLAN
 SCALE: 1" = 70'
 DATE: 01/05/21

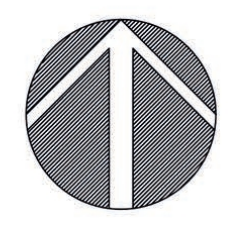
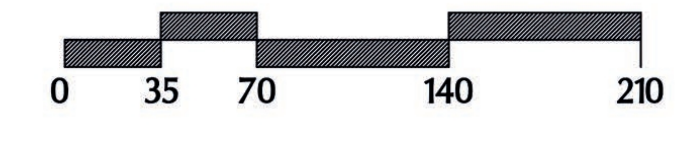

L1.0

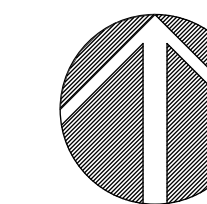
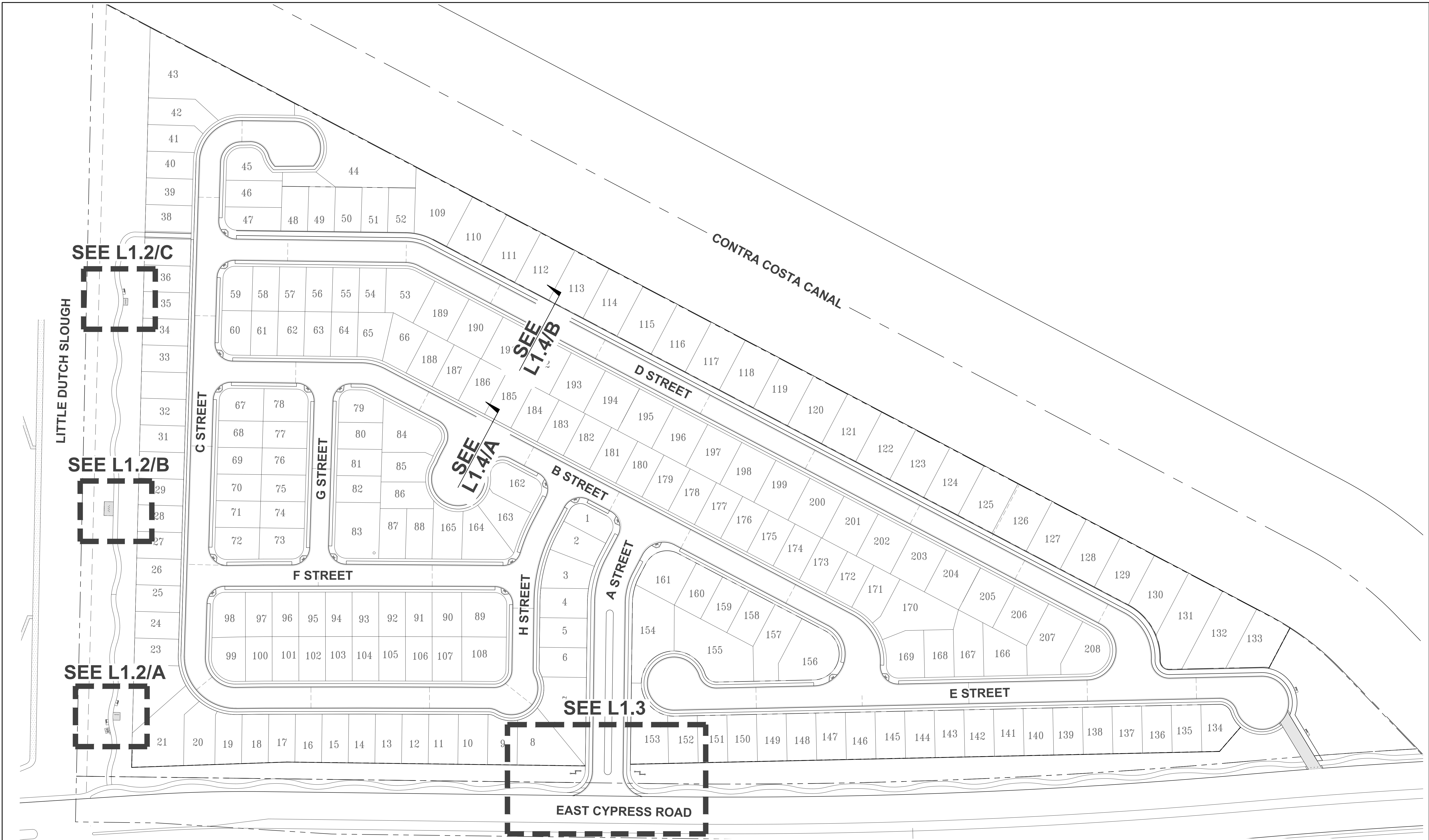

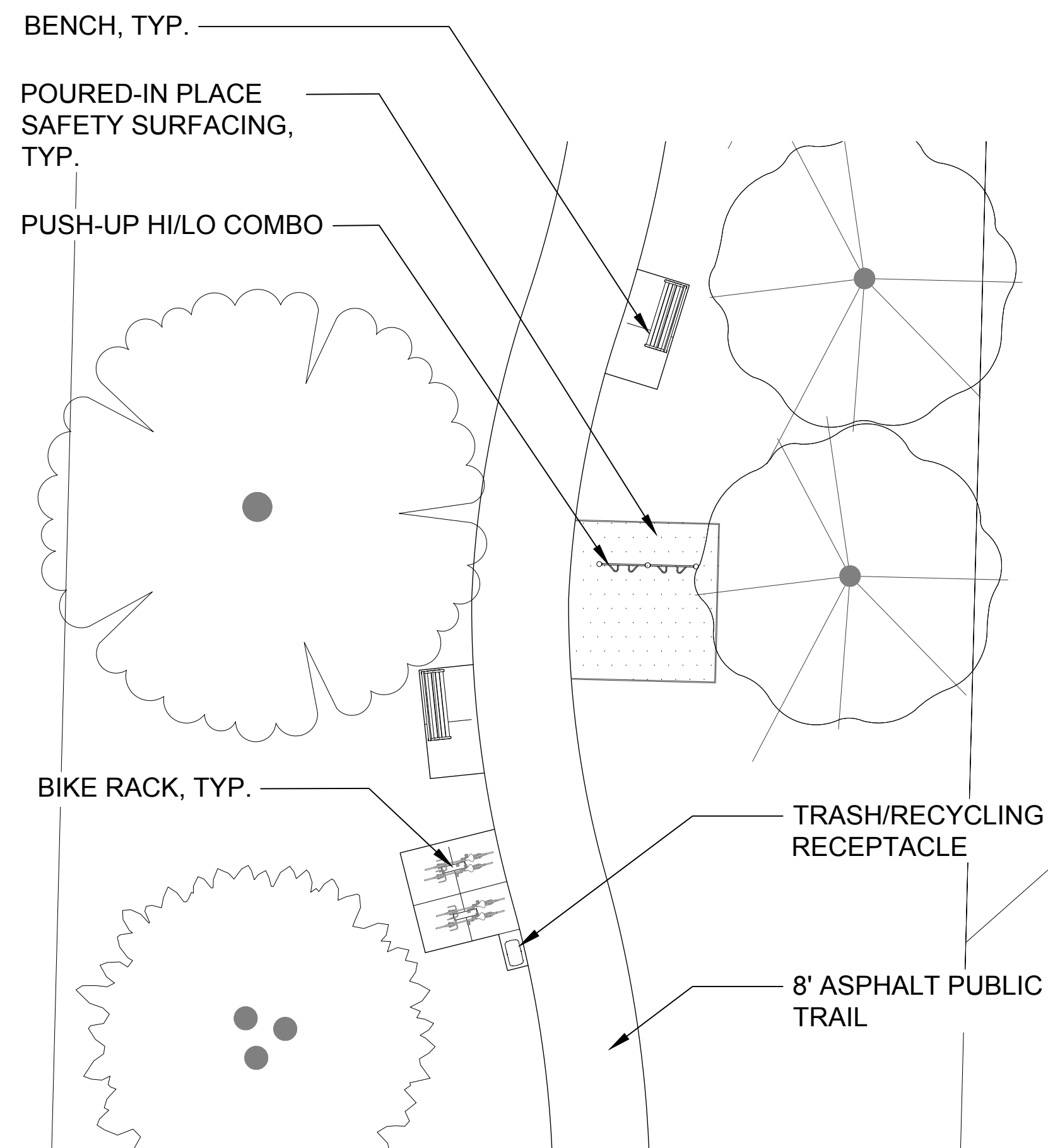

A FITNESS STATION ENLARGEMENT

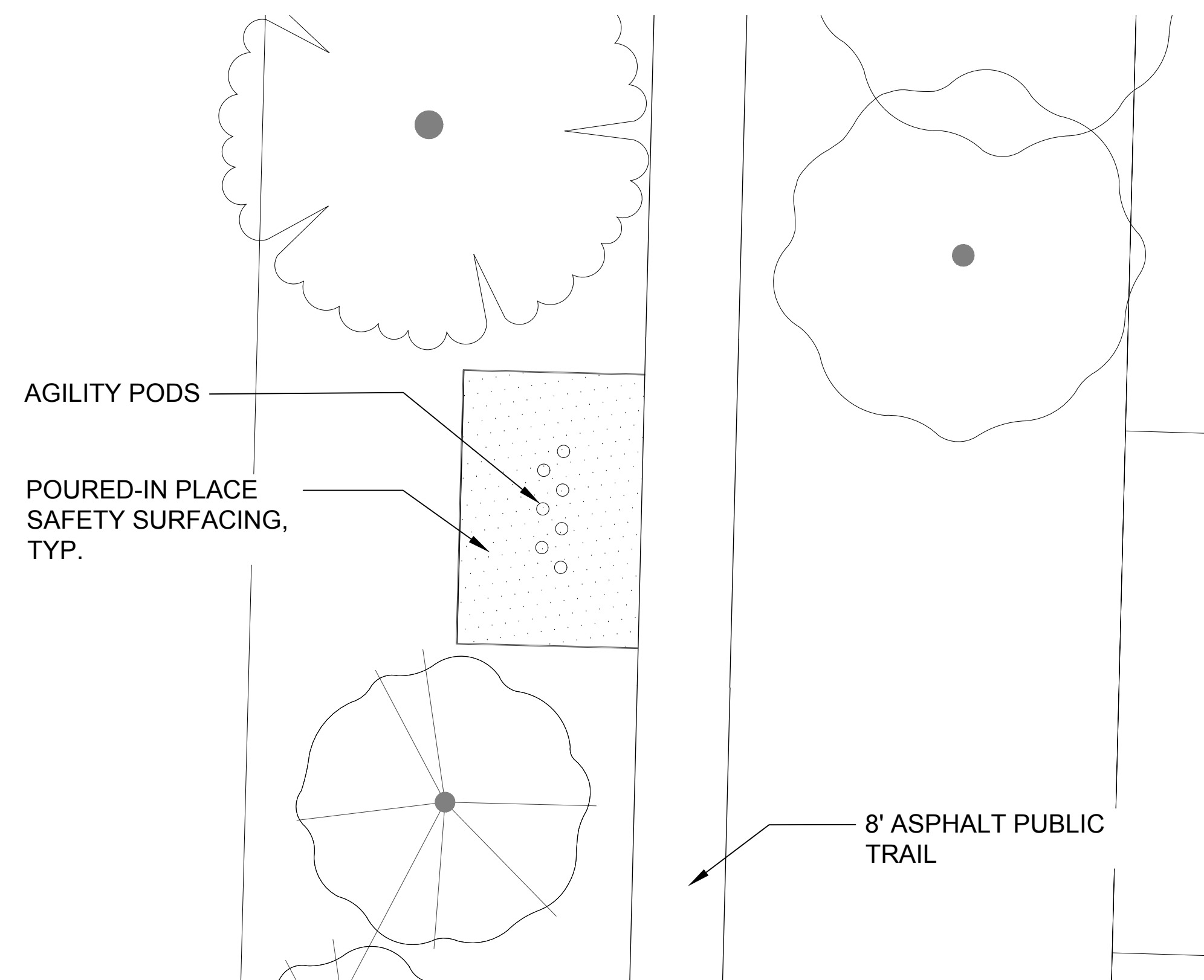

B FITNESS STATION ENLARGEMENT

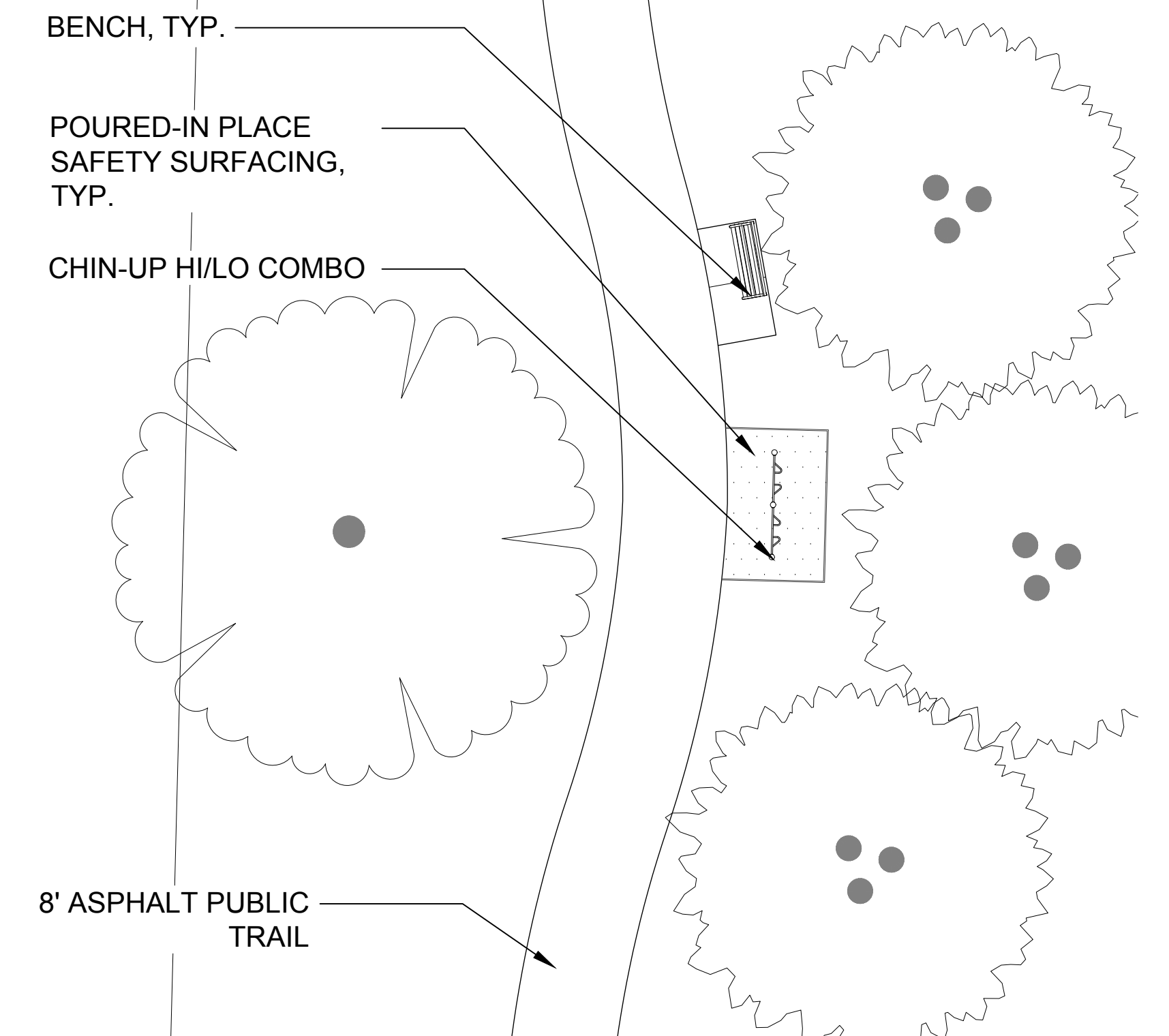

C FITNESS STATION ENLARGEMENT

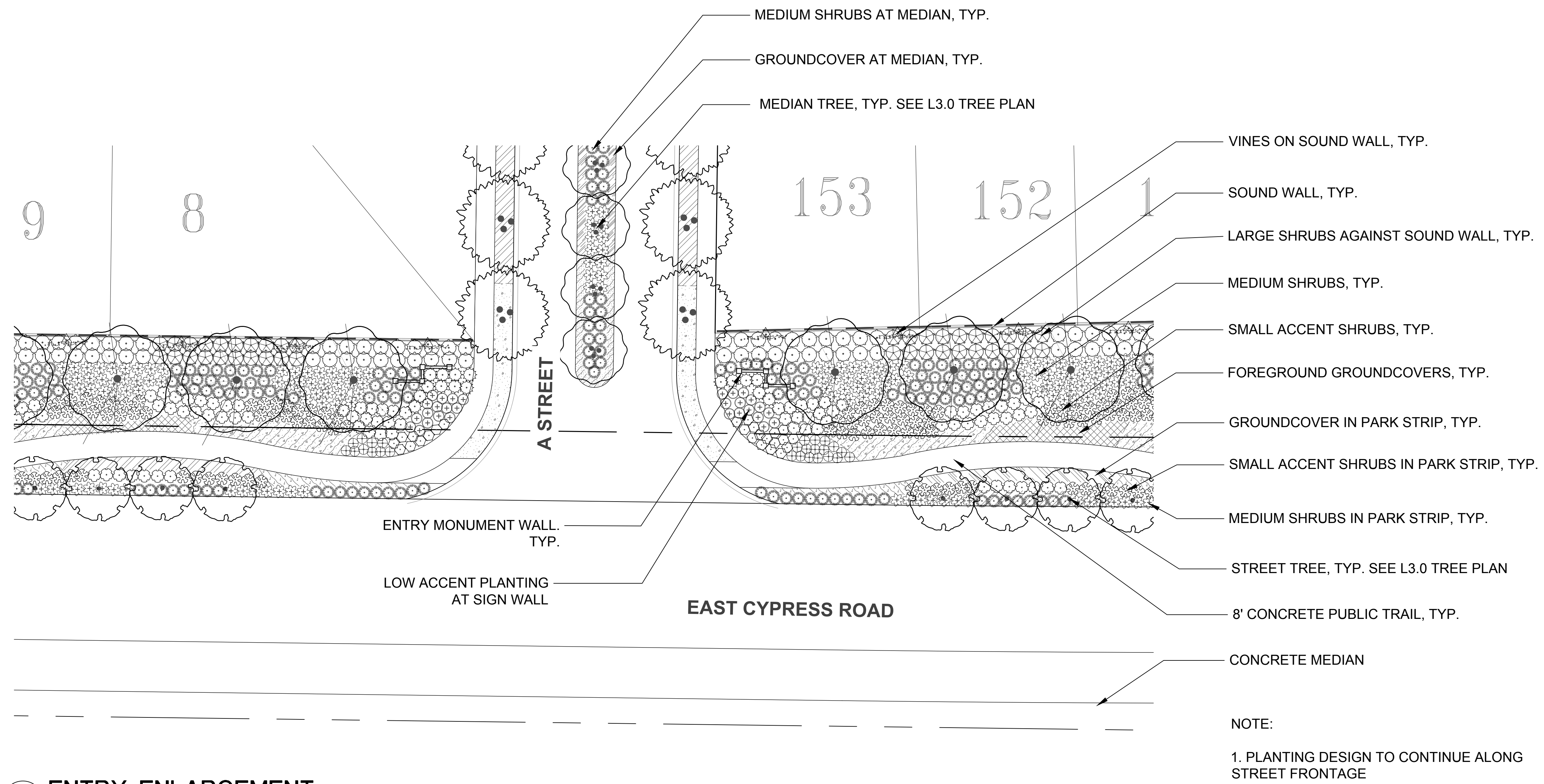

A ENTRY ENLARGEMENT

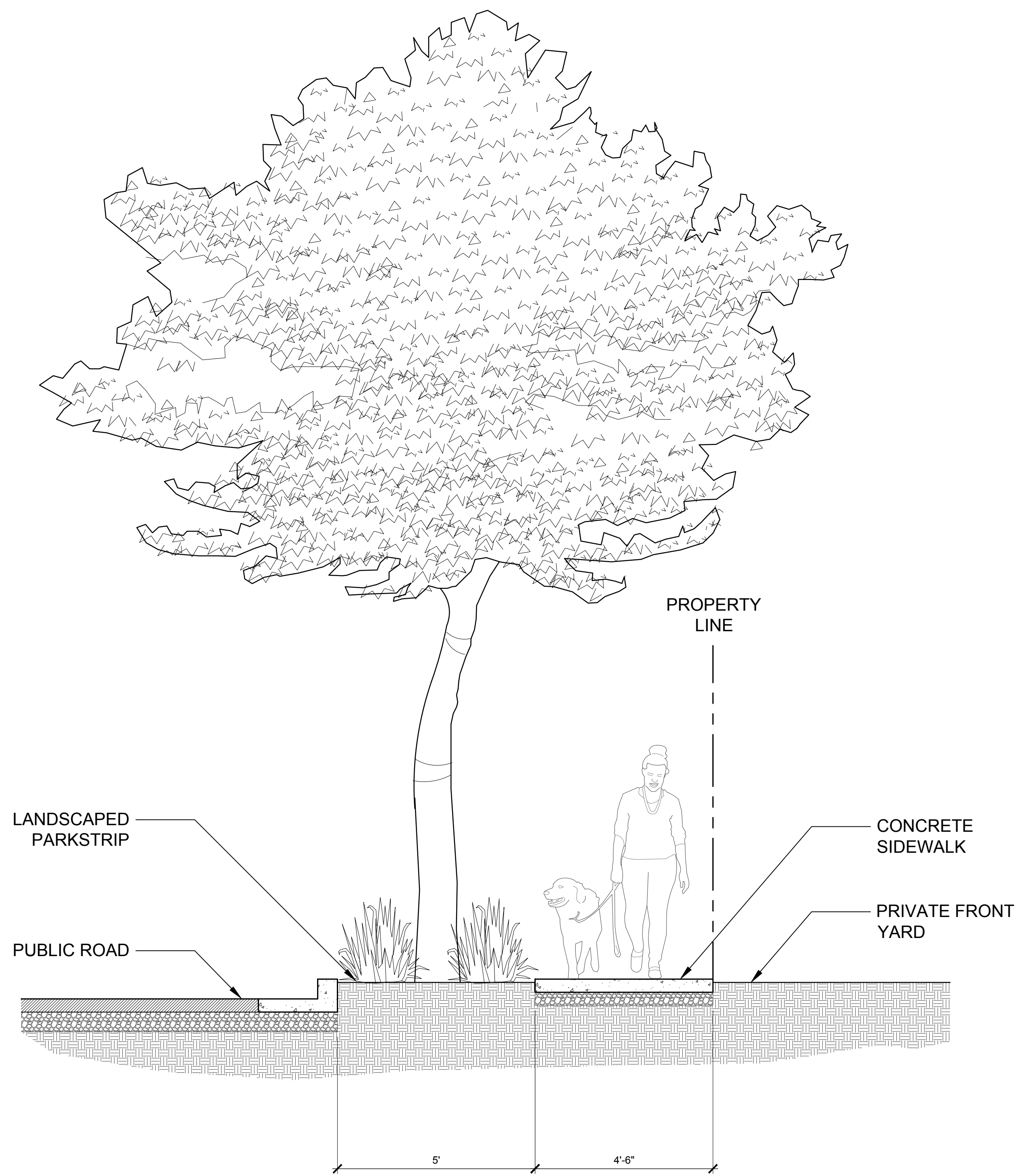

A TYPICAL SIDEWALK SECTION

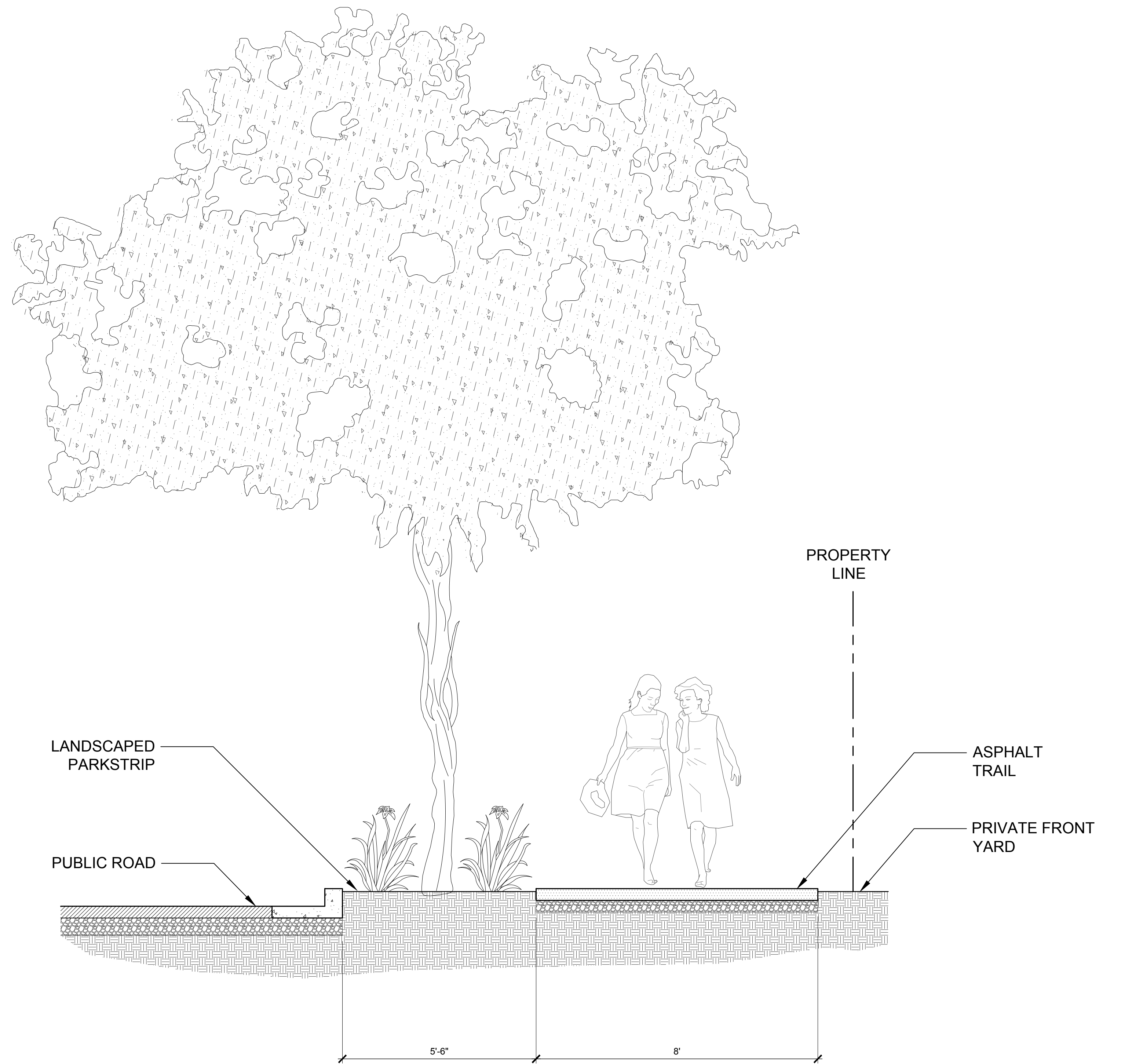

B TYPICAL TRAIL SECTION



**GOOD NEIGHBOR
FENCE**



VIEW FENCE



SOUND WALL

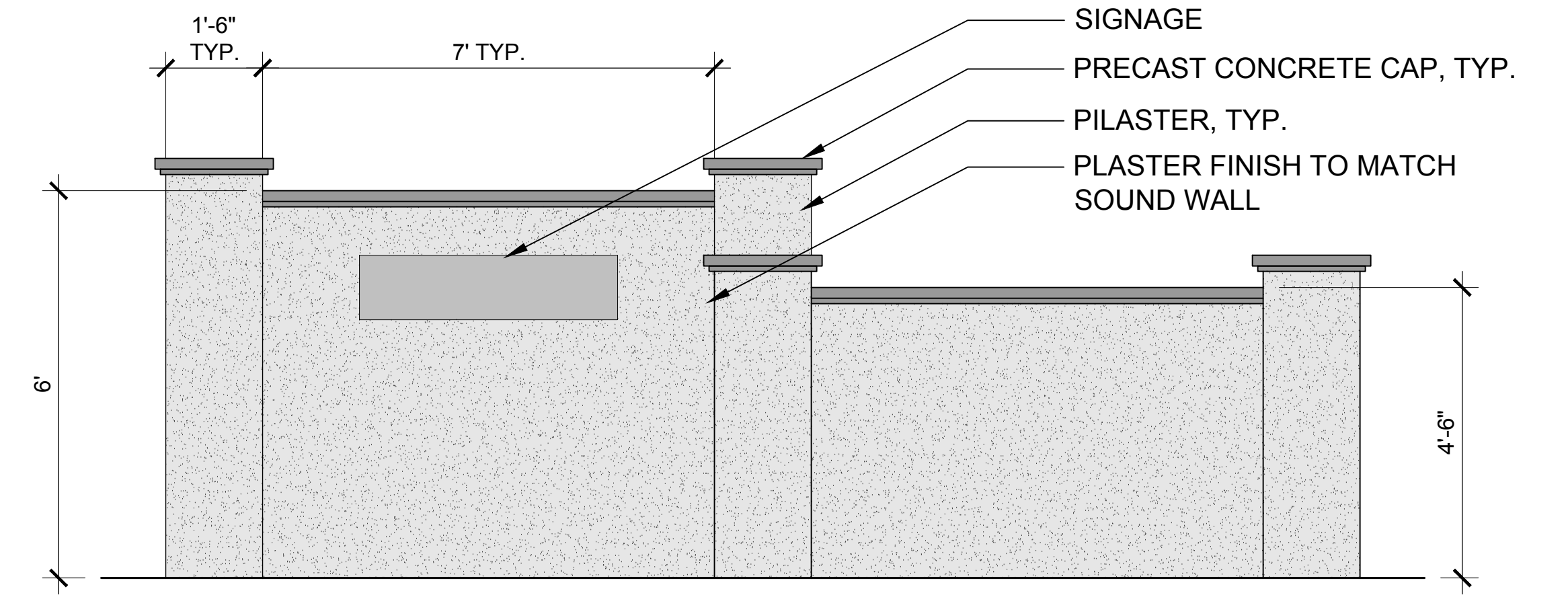

ENTRY MONUMENT WALL

SCALE: 1/2" = 1'-0"



**OUTDOOR FITNESS
SAFETY SURFACING**



GREEN



AGILITY PODS

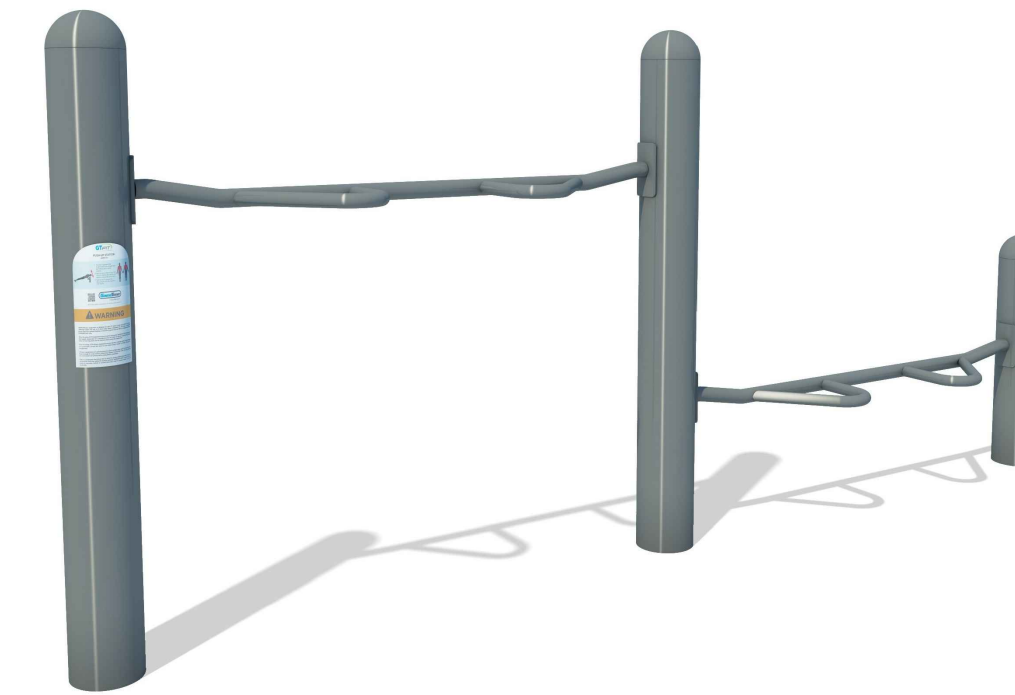

PUSH UP COMBO



CHIN UP COMBO



ASPHALT TRAIL



BENCH



BIKE RACK



**TRASH / RECYCLING
RECEPTACLE**



**REMOVABLE
BOLLARD**



Acer rubrum 'Red Sunset'
Red Sunset Maple



x Chitalpa tashkentensis
Chitalpa



Crataegus phaenopyrum
Washington Hawthorn



Ginkgo biloba
Maidenhair Tree



Ginkgo biloba 'Princeton Sentry'
Princeton Sentry Maidenhair Tree



Koelreuteria bipinnata
Chinese Flame Tree

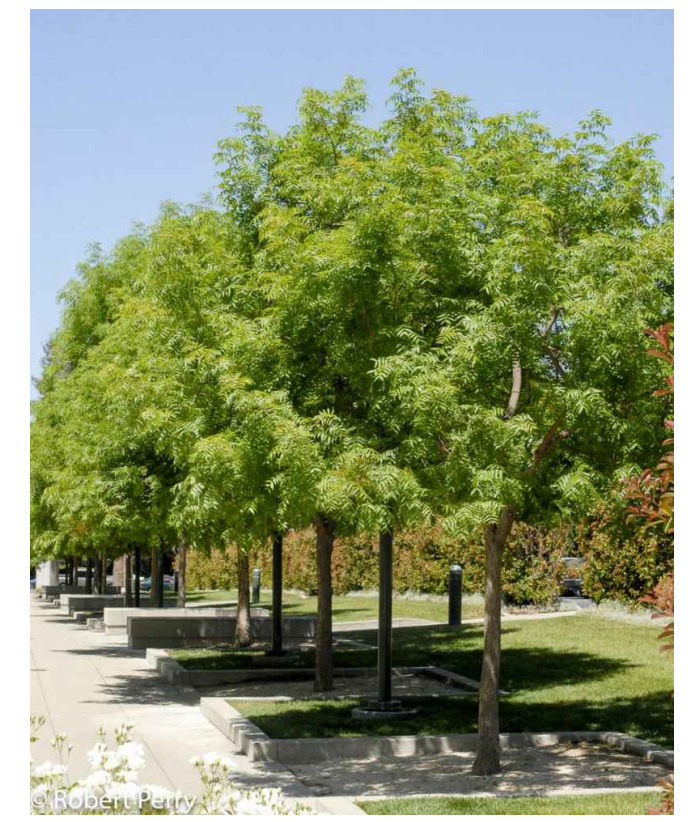

Pistacia chinensis
Chinese Pistache



Pyrus calleryana 'New Bradford'
New Bradford Flowering Pear



Quercus ilex
Holly Oak



Robinia 'Purple Robe'
Locust



Tristanopsis laurina 'Elegant'
Elegant Water Gum



Ulmus parvifolia
Chinese Elm

TREES



SHRUBS

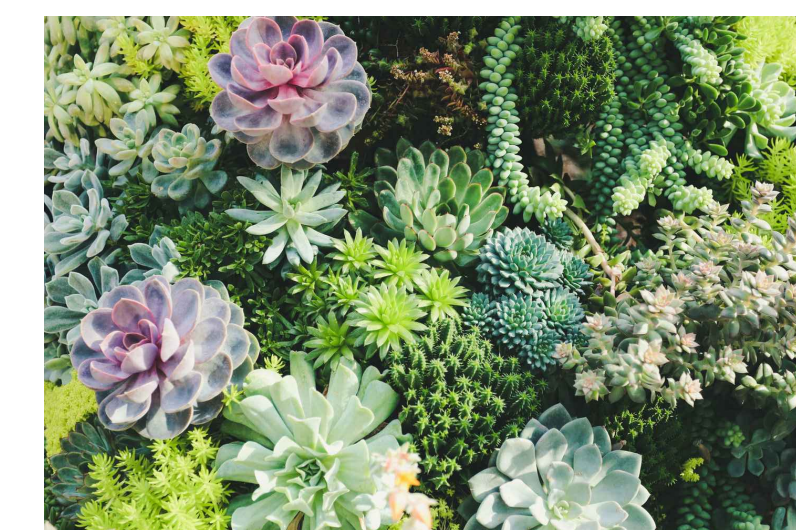
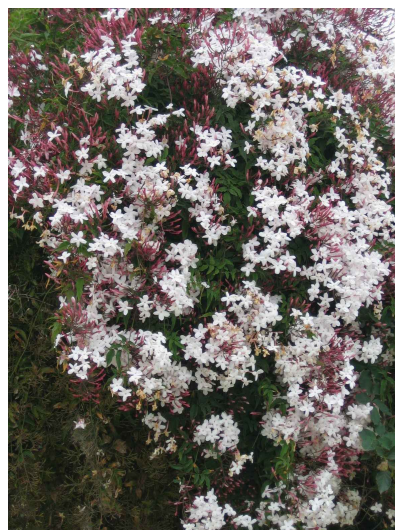

VINES

GROUNDCOVER

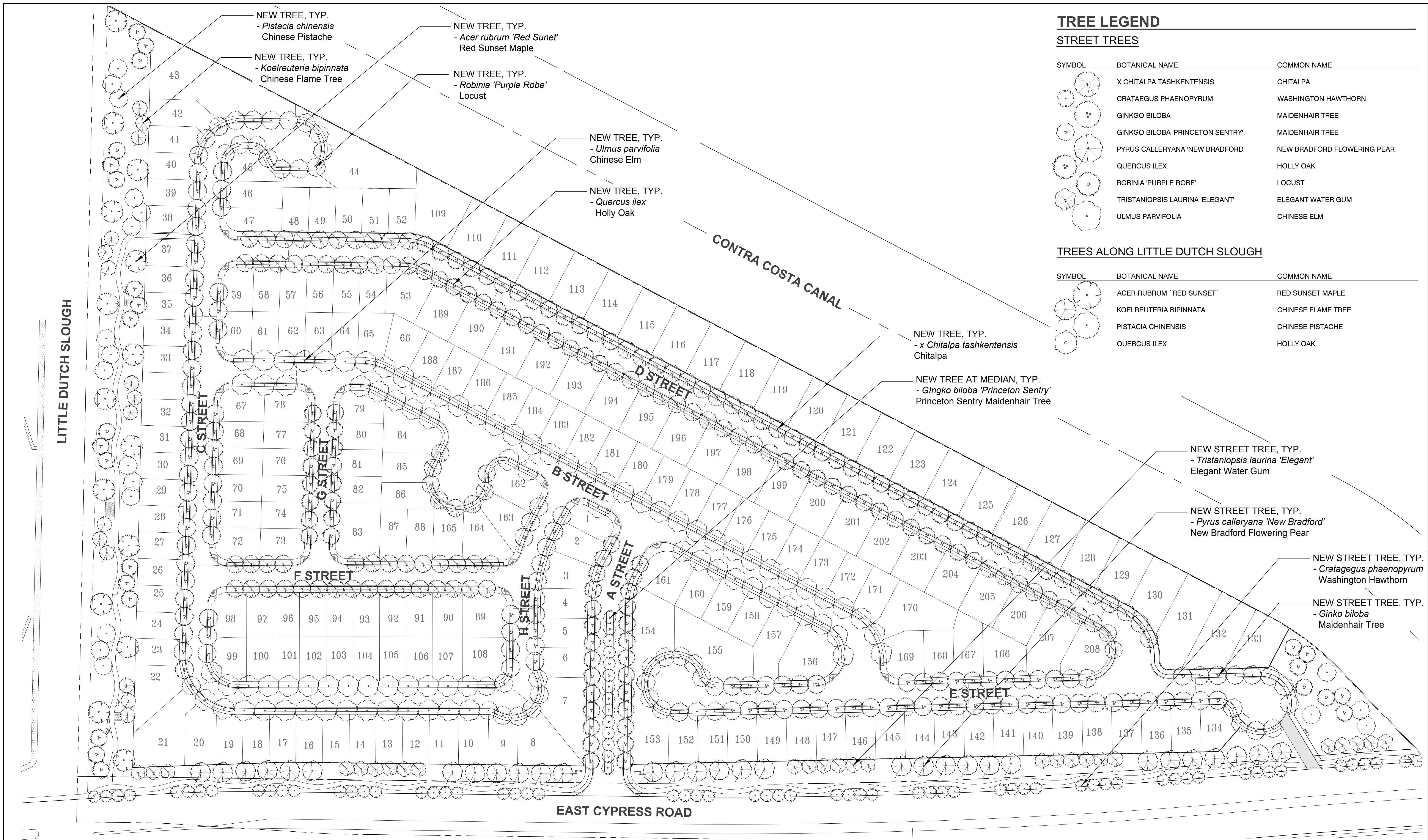

TREE LEGEND

STREET TREES

SYMBOL	BOTANICAL NAME	COMMON NAME
	X CHITALPA TASHKENTENSIS	CHITALPA
	CRATAEGUS PHAENOPYRUM	WASHINGTON HAWTHORN
	GINKGO BILOBA	MAIDENHAIR TREE
	GINKGO BILOBA 'PRINCETON SENTRY'	MAIDENHAIR TREE
	PYRUS CALLERYANA 'NEW BRADFORD'	NEW BRADFORD FLOWERING PEAR
	QUERCUS ILEX	HOLLY OAK
	ROBINIA 'PURPLE ROBE'	LOCUST
	TRISTANIOPSIS LAURINA 'ELEGANT'	ELEGANT WATER GUM
	ULMUS PARVIFOLIA	CHINESE ELM

TREES ALONG LITTLE DUTCH SLOUGH

SYMBOL	BOTANICAL NAME	COMMON NAME
	ACER RUBRUM 'RED SUNSET'	RED SUNSET MAPLE
	KOELREUTERIA BIPINNATA	CHINESE FLAME TREE
	PISTACIA CHINENSIS	CHINESE PISTACHE
	QUERCUS ILEX	HOLLY OAK

NEW TREE, TYP.
- *Pistacia chinensis*
Chinese Pistache

NEW TREE, TYP.
- *Acer rubrum* 'Red Sunset'
Red Sunset Maple

NEW TREE, TYP.
- *Robinia* 'Purple Robe'
Locust

NEW TREE, TYP.
- *Ulmus parvifolia*
Chinese Elm

NEW TREE, TYP.
- *Quercus ilex*
Holly Oak

NEW TREE, TYP.
- x *Chitalpa tashkentensis*
Chitalpa

NEW TREE AT MEDIAN, TYP.
- *Ginkgo biloba* 'Princeton Sentry'
Princeton Sentry Maidenhair Tree

NEW STREET TREE, TYP.
- *Tristaniopsis laurina* 'Elegant'
Elegant Water Gum

NEW STREET TREE, TYP.
- *Pyrus calleryana* 'New Bradford'
New Bradford Flowering Pear

NEW STREET TREE, TYP.
- *Crataegus phaenopyrum*
Washington Hawthorn

NEW STREET TREE, TYP.
- *Ginkgo biloba*
Maidenhair Tree

LITTLE DUTCH SLOUGH

CONTRA COSTA CANAL

EAST CYPRESS ROAD

C STREET

G STREET

F STREET

H STREET

A STREET

B STREET

D STREET

E STREET

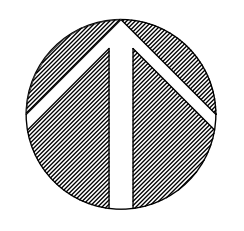

TREE PALETTE

STREET TREES

SYMBOL	BOTANICAL NAME	COMMON NAME	CONT	WATER USE	MATURE HEIGHT & SPREAD
	X CHITALPA TASHKENTENSIS	CHITALPA	24" BOX	L	35'H X 30'W
	CRATAEGUS PHAENOPYRUM	WASHINGTON HAWTHORN	24" BOX	M	30'H X 20'W
	GINKGO BILOBA	MAIDENHAIR TREE	24" BOX	M	35'-50'H X 25'-40'W
	GINKGO BILOBA 'PRINCETON SENTRY'	MAIDENHAIR TREE	24" BOX	M	45'H X 20'W
	PYRUS CALLERYANA 'NEW BRADFORD'	NEW BRADFORD FLOWERING PEAR	24" BOX	M	30'H X 35'W
	QUERCUS ILEX	HOLLY OAK	24" BOX	L	30-60'H X 30-60'W
	ROBINIA 'PURPLE ROBE'	LOCUST	24" BOX	L	40'H X 30'W
	TRISTANIOPSIS LAURINA 'ELEGANT'	ELEGANT WATER GUM	24" BOX	M	30'H X 30'W
	ULMUS PARVIFOLIA	CHINESE ELM	24" BOX	M	45'H X 35'W

TREES ALONG LITTLE DUTCH SLOUGH

SYMBOL	BOTANICAL NAME	COMMON NAME	CONT	WATER USE	MATURE HEIGHT & SPREAD
	ACER RUBRUM 'RED SUNSET'	RED SUNSET MAPLE	24" BOX	M	35'H X 35'W
	KOELREUTERIA BIPINNATA	CHINESE FLAME TREE	24" BOX	M	25'-40'H X 25'-30'W
	PISTACIA CHINENSIS	CHINESE PISTACHE	24" BOX	L	35'H X 30'W
	QUERCUS ILEX	HOLLY OAK	24" BOX	L	30-60'H X 30-60'W

MEDIUM ACCENT TREES (FRONT YARDS)

SYMBOL	BOTANICAL NAME	COMMON NAME	CONT	WATER USE	MATURE HEIGHT & SPREAD
	CARPINUS BETULUS 'FASTIGIATA'	EUROPEAN HORNBEAM	15 GAL	M	30'H X 25'W
	CERCIS CANADENSIS	EASTERN REDBUD	15 GAL	M	25'-35'H X 25'-35'W
	CRATAEGUS PHAENOPYRUM	WASHINGTON HAWTHORN	15 GAL	M	30'H X 20'W
	GINKGO BILOBA 'PRICETON SENTRY'	MAIDENHAIR TREE	15 GAL	M	45'H X 20'W
	LAURUS NOBILIS 'SARATOGA'	SWEET BAY	15 GAL	L	30'H X 20'W
	LYONOTHAMNUS FLORIBUNDUS	IRONWOOD	15 GAL	L	30'H X 20'W
	ROBINIA 'PURPLE ROBE'	LOCUST	15 GAL	L	40'H X 30'W
	PISTACIA CHINENSIS	CHINESE PISTACHE	15 GAL	L	35'H X 30'W

SMALL ACCENT TREES (FRONT YARDS)

SYMBOL	BOTANICAL NAME	COMMON NAME	CONT	WATER USE	MATURE HEIGHT & SPREAD
	ACER PALMATUM 'SANGO KAKU'	CORAL BARK MAPLE	15 GAL	M	25'H X 20'W
	GEIJERA PARVIFLORA	AUSTRALIAN WILLOW	15 GAL	L	25'H X 20'W
	LAGERSTROEMIA 'MUSKOGEE'	CRAPE MYRTLE	15 GAL	L	25'H X 15'W
	MAGNOLIA X SOULANGEANA	SAUCER MAGNOLIA	15 GAL	M	25'H X 25'W
	PRUNUS YEDOENSIS 'AKEBONO'	FLOWERING CHERRY	15 GAL	M	25'H X 25'W
	RHUS LANCEA	AFRICAN SUMAC	15 GAL	L	20'H X 20'W

PLANT PALETTE

SHRUBS

SYMBOL	BOTANICAL NAME	COMMON NAME	CONT	WATER USE	MATURE HEIGHT & SPREAD
	LAVATERA ASSURGENTIFLORA	MALLOW	5 GAL	L	10'H X 10'W
	NANDINA DOMESTICA	HEAVENLY BAMBOO	5 GAL	L	6'H X 4'W
	PITTIOSPORUM TOBIRA 'VARIAGATA'	VARIAGATED TOBIRA	5 GAL	L	5'H X 5'W
	PRUNUS CAROLINIANA 'BRIGHT 'N TIGHT'	CAROLINA LAUREL	5 GAL	L	8'H X 7'W
	RHAPIOLEPIS INDICA 'SPRINGTIME'	INDIAN HAWTHORN	5 GAL	L	5'H X 5'W
	XYLOSMA CONGESTUM	SHINY XYLOSMA	5 GAL	L	10'H X 10'W
	ANISODONTEA X HYPOMANDARUM	CAPE MALLOW	5 GAL	M	4'H X 4'W
	ASPIDISTRA ELATIOR	CAST IRON PLANT	1 GAL	L	3'H X 3'W
	CAMELLIA SASANQUA 'SHISHI GASHIRA'	SHISHI GASHIRA CAMELLIA	5 GAL	M	3'H X 6'W
	COLEONEMA PULCHRUM	PINK BREATH OF HEAVEN	5 GAL	M	5'H X 5'W
	DIETES BICOLOR	FORTNIGHT LILY	1 GAL	L	3'H X 3'W
	EURYOPS SPECIES	DAISY	5 GAL	L	4'H X 4'W
	FESTUCA MAIREI	ATLAS FESCUE	1 GAL	L	3'H X 3'W
	GREVILLEA 'NOELII'	GREVILLEA	5 GAL	L	4'H X 5'W
	LAVANDULA ANGUSTIFOLIA	ENGLISH LAVENDER	1 GAL	L	2'H X 3'W
	LOMANDRA LONGIFOLIA 'BREEZE'	DWARF MAT RUSH	1 GAL	L	3'H X 3'W
	LORAPETALUM 'SHANG-WHITE'	EMERALD SNOW FRINGE	5 GAL	L	4'H X 3'W
	NEPHROLEPIS CORDIFOLIA	SOUTHERN SWORD FERN	1 GAL	M	3'H X 3'W
	PHORMIUM HYBRIDS	FLAX	5 GAL	L	4'H X 3'W
	PIERIS JAPONICA 'PRELUDE'	JAPANESE PIERIS	5 GAL	M	3'H X 3'W
	ROSA 'FLOWER CARPET PINK'	GROUNDCOVER ROSE	2 GAL	M	2'H X 3'W
ROSA FLORIBUNDAS 'ICEBERG'	ICEBERG ROSE	5 GAL	M	4'H X 4'W	
ROSMARINUS OFFICINALIS 'TUSCAN BLUE'	ROSEMARY	5 GAL	L	6'H X 3'W	
SALVIA SPECIES	SAGE	5 GAL	L	3.5'H X 3'	
	WESTRINGIA FRUTICOSA 'MORNING LIGHT'	COASTAL ROSEMARY	5 GAL	L	3.5'H X 3.5'W
	AGAPANTHUS SPECIES	LILY OF THE NILE	1 GAL	M	2'H X 2'W
	CALLISTEMON 'LITTLE JOHN'	BOTTLE BRUSH	1 GAL	L	3'H X 3'W
	FESTUCA OVINA GLAUCA	BLUE FESCUE	1 GAL	L	1'H X 1'W
	LANTANA 'DWARF YELLOW'	DWARF LANTANA	1 GAL	L	2'H X 3'W
	LIRIOPE MUSCARI	LILYTURF	1 GAL	M	2'H X 2'W
	PHORMIUM HYBRIDS 'TONEY TIGER'	FLAX	1 GAL	L	2'H X 2'W
	SANTOLINA VIRENS	GREEN LAVENDER COTTON	1 GAL	L	2.5'H X 2.5'W

VINES

SYMBOL	BOTANICAL NAME	COMMON NAME	CONT	WATER USE	MATURE HEIGHT & SPREAD
	CLEMATIS ARMANDII	EVERGREEN CLEMATIS	15 GAL	M	15'H X 15'W
	CLYTOSTOMA CALLISTEGIOIDES	VIOLET TRUMPET VINE	15 GAL	M	17'H X 17'W
	HARDENBERGIA VIOLACEA 'HAPPY WANDERER'	LILAC VINE	15 GAL	M	14'H X SPREADING
	JASMINUM POLYANTHUM	JASMINE	15 GAL	M	25'W X SPREADING
	ROSA BANKSIAE 'LUTEA'	BANKSIA ROSE	15 GAL	M	17'H X 20'W

GROUNDCOVER

SYMBOL	BOTANICAL NAME	COMMON NAME	CONT	WATER USE	MATURE HEIGHT & SPREAD
	ARCTOSTAPHYLOS SPECIES	CARPET MANZANITA	1 GAL	L	1'H X 5'W
	ECHVEERIA SPECIES	ECHVEERIA	4" POT	L	6'H X 6'W
	ERODIUM REICHARDII	ALPINE GERANIUM	4" POT	L	3'H X 12'W
	CEANOTHUS SPECIES	CALIFORNIA LILAC	1 GAL	VL	1'H X 10'W
	CORPOSMA KRIKII 'VARIEGATA'	CREEPING CORPOSMA	1 GAL	L	1'H X 5'W
	MYOPORUM PARVIFOLIUM	MYOPORUM	1 GAL	L	1'H X 7'W
	SEDUM SPECIES	STONECROP	4" POT	L	1'H X 2'W

PLANTING DESIGN INTENT STATEMENT

The planting design utilizes primarily drought tolerant, low and medium water use plant materials located in separate hydrozones. Shade tolerant, low and medium water use plants will be utilized on the North facing sides of the project. Low water use plants will be used in all other planted areas. The plants will be selected utilizing the State of California's Model Water Efficient Landscape Ordinance plant list and ET Calc water management computer software. A minimum of 3" of bark mulch will be placed in all shrub and groundcover areas.

WATER USE DESIGN INTENT STATEMENT

The irrigation system will comply with the State of California's Model Water Efficient Landscape Ordinance as adopted by the City of Oakley. System will be a fully automatic, low gallon system with matched precipitation rate emitters on each circuit. The low and medium water use hydrozones will be on separate valve circuits. All new trees will have separate drip or bubbler circuits. The remote control valves will have integral pressure regulators to prevent fluctuations and ensure constant application rates to minimize over or under watering. The electronic irrigation controller will be weather based and make automatic adjustments based on current climate along with multiple programs and application cycles/start times. A rain switch will be installed to prevent irrigation during rainy periods. A flow sensor and master valve will be connected to the controller to allow automatic shut off of any valve circuit or main line in the event of a pipe brake to prevent water waste.